

NOSE WHEELS

MATCO NOSE WHEELS

Matco Part No.	Our Part No.	Dia. (in.)	Bearing Axle Dia.	Bearing Type Sealed	Width	Static Capacity (lbs.)	Load Limit (lbs.)	Weight (lbs.)	Price
Material: Spun Aluminum									
MH6N	06-00537	6	0.625	Ball	5.325	660	2000	2.6	---
MH6N-S	06-00539	6	0.625	Ball	5.325	660	2000	2.6	---
MH6N.75	06-00538	6	0.75	Ball	5.325	660	2000	2.6	---
Material: CNC Cast Aluminum									
NW40B	06-00541	4	6.25	Ball	3	660	2000	2.25	---
NW40B.75	06-00542	4	0.75	Ball	3	660	2000	2.25	---
NW40R	06-00543	4	0.75	Taper/Roll	3	1185	3560	2.25	---
NW50	06-00544	5	0.75	Taper/Roll	3.88	1185	3560	3.24	---
NW51	06-00545	5	0.75	Taper/Roll	3.88	1185	3560	3.24	---
NW501.25	06-00546	5	1.25	Taper/Roll	3.88	1420	4260	3.24	---
NW511.25	06-00547	5	1.25	Taper/Roll	3.88	1420	4260	3.6	---
NW60	06-00548	6	1.25	Taper/Roll	3.5	1420	4260	3.24	---
NW600	06-00549	6	1.25	Taper/Roll	4.5	1420	4260	3.24	---
Material: Die Cast Aluminum									
NW40EE	06-00550	4	0.625	Ball	3.25	660	2000	1.8	---
NW50CC	06-00551	5	0.625	Ball	4.38	660	2000	2.7	---
NW50CC.75	06-00552	5	0.75	Ball	4.38	660	2000	2.7	---
NW51CC	06-00553	5	0.625	Ball	4.38	660	2000	2.7	---
NW51CC.75	06-00554	5	0.75	Ball	4.38	660	2000	2.7	---
NW50CC.75R	06-00555	5	0.75	Taper/Roll	4.38	1185	3560	2.8	---
NW51CC75R	06-00556	5	0.75	Taper/Roll	4.38	1185	3560	2.8	---
NW60CC	06-00557	6	0.625	Ball	4.38	660	2000	3.22	---
NW60CC.75	06-00558	6	0.75	Ball	4.38	660	2000	3.22	---
NW60CC.75R	06-00559	6	0.75	Taper/Roll	4.38	1185	3560	3.52	---
NW600CC	06-00560	6	0.625	Ball	5.38	660	2000	3.47	---
NW600CC.75	06-00561	6	0.75	Ball	5.38	660	2000	3.47	---
NW600CC.75R	06-00562	6	0.75	Taper/Roll	5.38	1185	3560	3.52	---

MATCO 6 INCH PNEUMATIC NOSE WHEEL ASSEMBLY



MATCO mfg produces the WHLTW35 inch nosewheel for use with aircraft requiring less than 660 pounds nosewheel load. Dimensions: The WHLTW35 uses 0.625 inch Sealed Ball bearings. It is 1.78 wide and weighs approximately 0.91 lbs. Performance: The WHLTW35 is designed for the following standards: • Static Capacity: 660 • Load Limit: 1980 • Also used in WHLT-6P Tailwheel • This wheel uses the TIRT6X2ASY tire & tube assembly. The wheel is rated at 660 lbs static but the tire is only rated at 250 lbs static. This is the lightest weight 6 inch pneumatic wheel available!P/N 06-01658

MATCO NOSEWHEEL



MATCO mfg produces the WHLTW40R nosewheel for use with aircraft requiring less than 1185 pounds nosewheel load. Dimensions: The WHLTW40R uses .75 inch tapered roller bearings. It is 2.6 wide and weighs approximately 2.1 lbs. Static Capacity: 1185. Load Limit: 3555. Tapered Roller Bearings: .75 inch. Wheel Assembly Width: 2.6. Weighs: appr. 2.1 lbs. P/N 06-02571

GROVE 400X4 NOSE WHEEL



The perfect nose wheel for light sport aircraft such as the KR and Soneri. • Static Load Rating 900lbs • Genuine Timkin Bearings • Uses 3/4" Axle • Felt Seals • Weight 1.98 lbs Model 49-1A..... P/N 06-00843 **TIRE:** Uses 400 x 8 ply tire.. P/N 06-00844 **TIRE:** Uses 4.10 x 3.50 x 4 ply tire P/N 06-08102

GO-CART WHEELS



Cast aluminum wheels with 4" hub, for homebuilts and sailplanes. Used on Tri-Q conversion as nose-wheel. 3-1/4" wide. Complete with 5/8" dia. ball bearings. Wt. 1-1/2 Lbs.....P/N 06-00550 **Ea.**

HEGAR 6" NOSE WHEEL



The 6" Spun Aluminum nose wheel with 5/8 bearings. Comes centered when using the MX o-ring standard wheel hub but can also be purchased with the MX offset hub (no o-ring with offset hub. Requires the use of a tube. Comes complete with nuts, bolts, washers, valve stem, o-rings if required and the MX hub. May also be used as main wheels. P/N 06-01274

CLEVELAND NOSE WHEELS 500X5

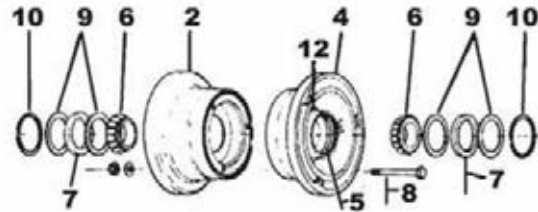

#	Old Part No.	Part No.	Description	Qty Per Assy.					Price Each
				40-77	40-77A	40-85	40-87	40-87A	
2	162-28	162-02800	Outer Wheel	1	1	-	-	-	---
	162-36	162-03600	Outer Wheel	-	-	-	-	1	---
	08231	214-00300	Cup Bearing	1	1	1	1	1	---
12	217-1	217-00100	Grommet	1	1	1	1	1	---
	4	161-31	161-03100	Inner Wheel Half Assy.	1	1	-	-	-
	161-38	161-03800	Inner Wheel Half Assy.	-	-	-	-	1	---
5	08231	214-00300	Inner Cup Bearing	1	1	1	1	1	---
8	103-1050	AN4-22A	Bolt	3	3	3	3	3	---
*	095-10400	AN960-416	Washer	6	6	6	6	6	---
*	094-10300	AN365-428A	Nut	3	3	3	3	3	---
9	153-8	153-00800	Ring-Grease Seal	4	4	-	-	-	---
	21-104	153-00200	Ring-Grease Seal	-	-	4	-	-	---
10	155-2	155-00200	Ring-Snap	2	2	2	2	2	---
7	154-6	154-00600	Felt-Grease Seal	2	2	-	-	-	---
6	08125	214-00400	Cone-Bearing	2	2	2	2	2	---

500 X 5 NOSE WHEEL dimensions: 6.625 in. x 6.625 in. x 7 in. P/N 40-77

500 X 5 NOSE WHEEL with 1-1/4" dia. bearings. Used on some models of Cessna 150, is typical of nose wheels used on general aviation aircraft. FAA-approved.....P/N 40-77A

500 X 5 NOSE WHEELS 1-1/2" Dia. Bearings used on Mooney Model 40-77B.....P/N 05-11661 Model 40-87.....P/N 06-00417 Model 40-87C.....P/N 06-00962

600 X 6 NOSE WHEEL with 1-1/2" dia. bearings. (not illustrated) is used on some models of Cessna 172 and 182. FAA approved. P/N 40-76A

600X6 Nose Wheel 40-76B.....P/N 05-13057

LG