



4908 McKenna Ct., Columbus, Ohio, 43221 USA  
(614) 876-6345  
[www.aircraftextras.com](http://www.aircraftextras.com) [sales@aircraftextras.com](mailto:sales@aircraftextras.com)

## Oil Quantity Sensor - Pre-order Form

(Oil Quantity Sensor Preorder Form 10-3-2024.pdf)

We require some information about your engine and installation in order to better serve you. Please fill out this form. If we have questions, we will contact you. NOTE: If you require a different type of sensor, please contact us. It may already be on our design list. You may send this 2 page form back to us via regular mail or email in the form of a \*.jpg or \*.pdf file.

NAME: \_\_\_\_\_

ADDRESS: \_\_\_\_\_

ADDRESS: \_\_\_\_\_ ( PLEASE PRINT CLEARLY )

CITY / STATE / ZIP: \_\_\_\_\_

E-MAIL: \_\_\_\_\_

PHONE: (Cell) \_\_\_\_\_ Phone (Home) \_\_\_\_\_

AIRCRAFT "N" NUMBER: \_\_\_\_\_ AIRCRAFT TYPE: \_\_\_\_\_

COMPLETE ENGINE "NAMEPLATE" MODEL NUMBER: \_\_\_\_\_

Are you ordering a (15PIN, DSUB conn. wired with 12" long #20AWG)? (extra charge\$) circle one Yes / No

Our "standard sensors" are now ordered without a Temperature Sensor. (by popular customer demand)

Do you want to order a sensor with a Temperature Sensor? (extra charge\$) circle one Yes / No

How will you display Oil Level/Temp? (Our AG6? EFIS model #?, other)? \_\_\_\_\_

**I am ordering a: (please fill in the proper boxes) PLEASE REFER INDIVIDUAL SENSOR DRAWINGS**

( [ ] Lycoming 1/2-NPT fitting) or ( [ ] Continental 5/8-18 fitting) or ( [ ] ULPower 14MMx1.5 fitting) type of sensor, or OTHER: \_\_\_\_\_, with a Sensor Length of \_\_\_\_\_ inches. (measurement starting at your oil pan fitting, outside fitting surface) with a Cable Length of \_\_\_\_\_ inches. (Sensor to Electronics, 48 inches is standard at no extra charge. (72 inches is the max. suggested.) If you are intend putting this sensor in a fitting position that you will remove the sensor to change oil, we could put connectors in-between the Electronics and the Sensor with an extra charge. Please contact us.

**Please acknowledge statements by writing your "INITIALS" in the the boxes.**

[ ] I have read and understand the document (Will this Sensor Fit 8-27-2024.pdf) The sensor size and cable lengths I am ordering complies with this document. I also understand that this Oil Quantity Sensor's oil quantity measurement is not to be used in substitution or in place of the standard oil quantity checks at preflight or otherwise for your aircraft.

SIGNATURE: \_\_\_\_\_ DATE: \_\_\_\_\_

PLEASE try to draw your oil sump or container similar to the example below. We would like to understand how many fittings there are in your oil pan or oil container and where you will put the sensor. You should use the fitting hole that will allow you to use the highest length sensor to measure the highest oil level.

EXAMPLE BELOW:

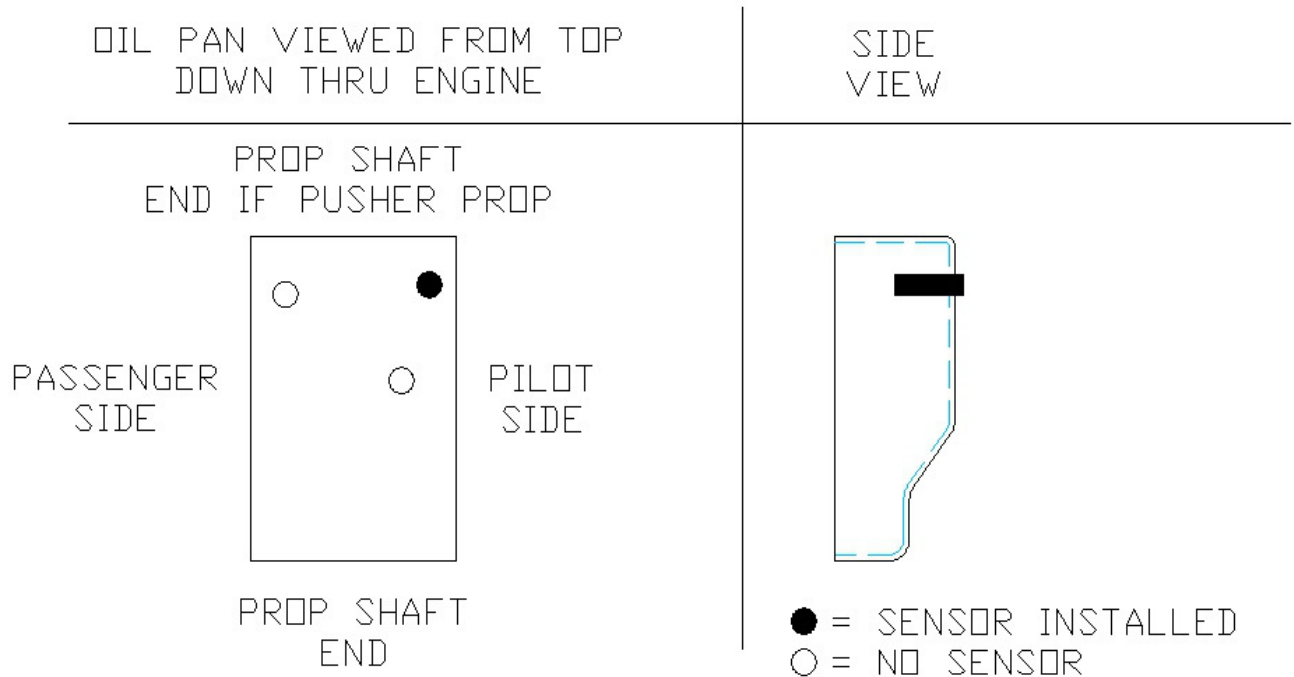

DRAW YOUR OIL PAN BELOW THIS LINE:

SIGNATURE: \_\_\_\_\_ DATE: \_\_\_\_\_

(On the web: [www.aircraftextras.com](http://www.aircraftextras.com), By e-mail: [sales@aircraftextras.com](mailto:sales@aircraftextras.com))