

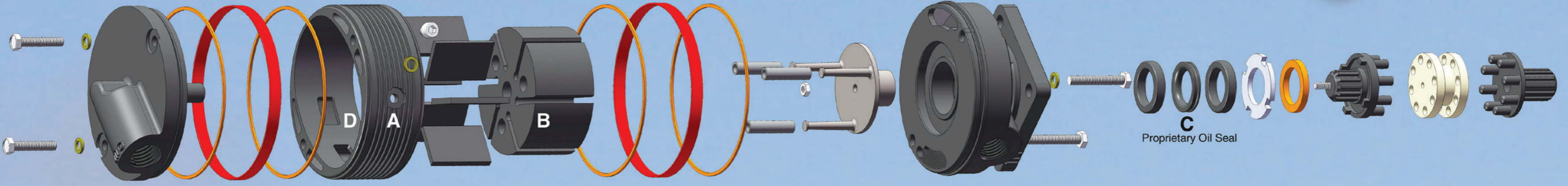

If you're going to get the best vacuum pump  
....make sure you select the right one!



For reference only. Images not to scale. Inspection port only on RAP part numbers.

Not all models shown

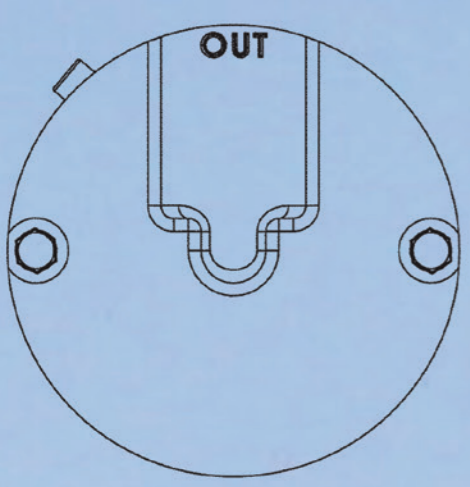

RAP215CC, RAP215CC-9  
215CC, 211CC & 211CC-9

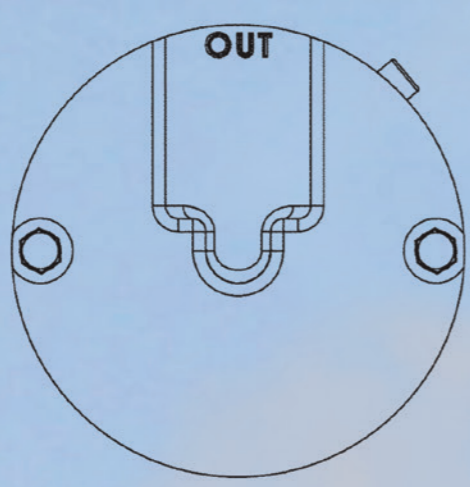

RAP216CW, 216CW & 212CW

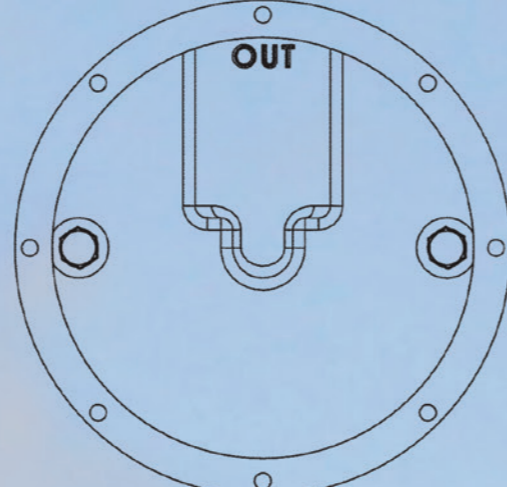

RAP241CC & 241CC

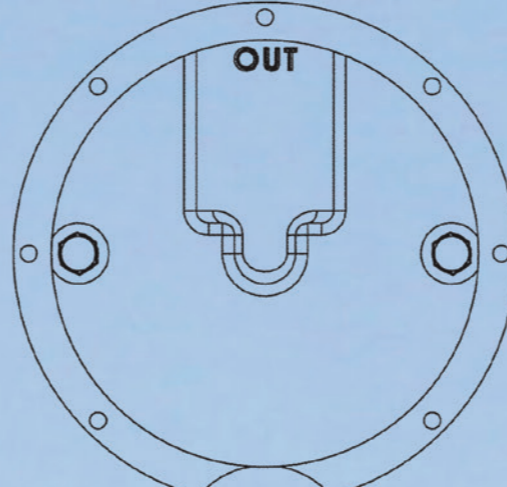

RAP241CC-13 & 241CC-13

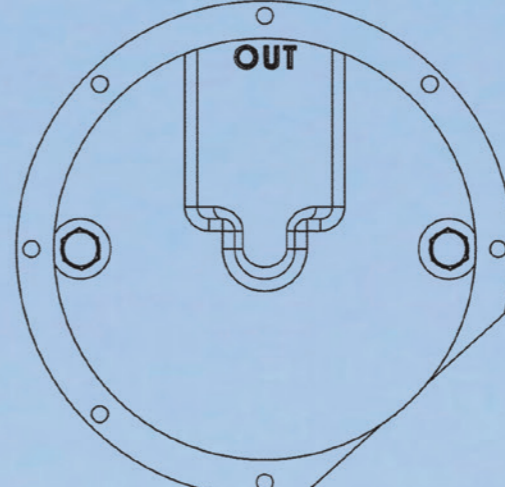

RAP241CC-15 & 241CC-15

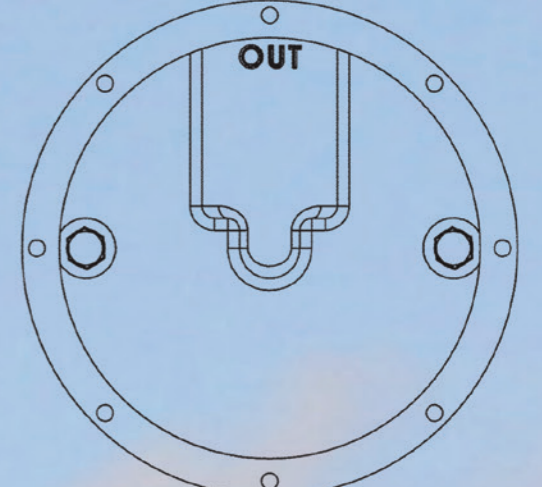

RAP242CW & 242CW

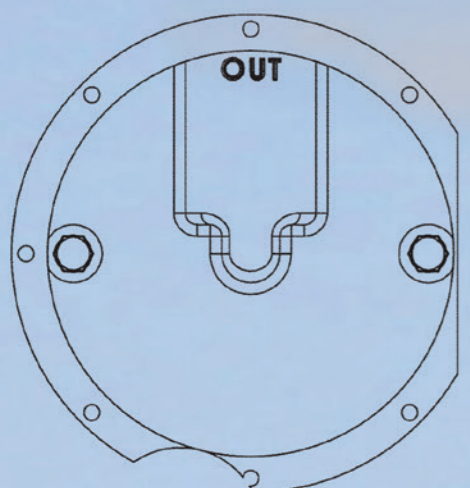

RAP242CW-4 & 242CW-4

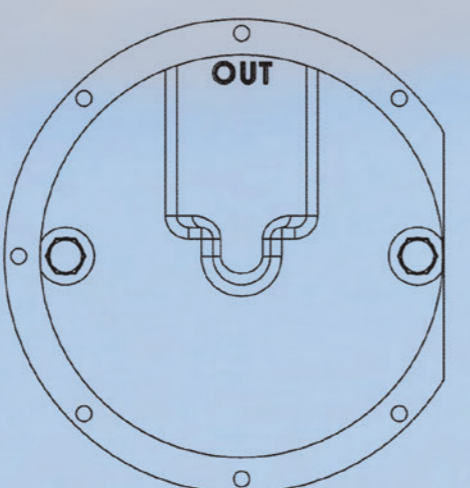

RAP242CW-10 & 242CW-10

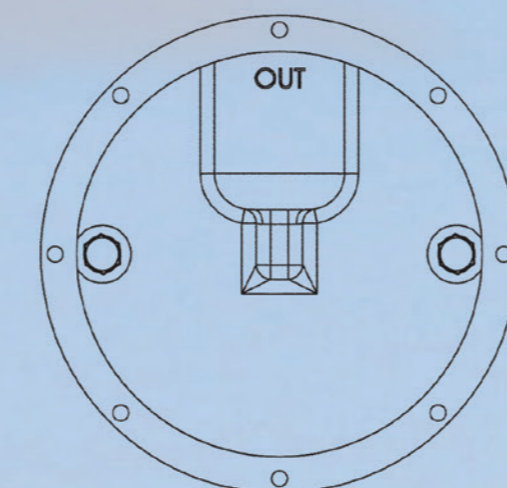

RAP441CC & 441CC

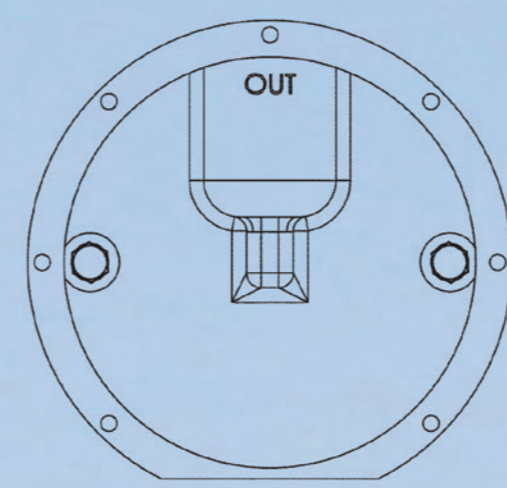

RAP441CC-3 & 441CC-3

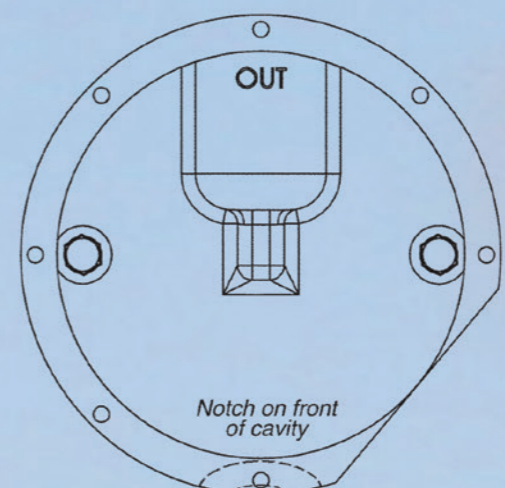

RAP441CC-7 & 441CC-7

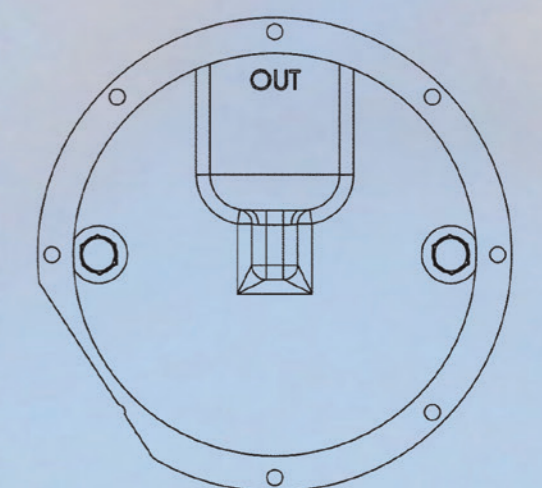

RAP441CC-9 & 441CC-9

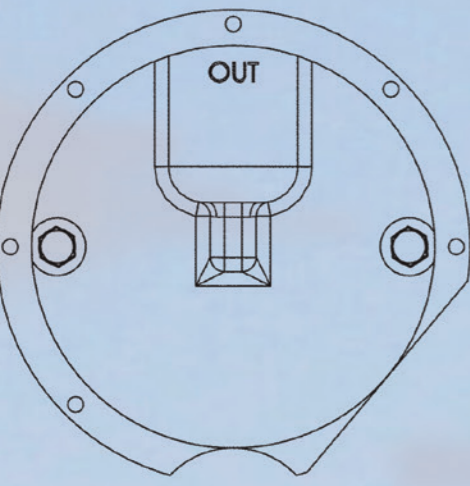

RAP441CC-17 & 441CC-17

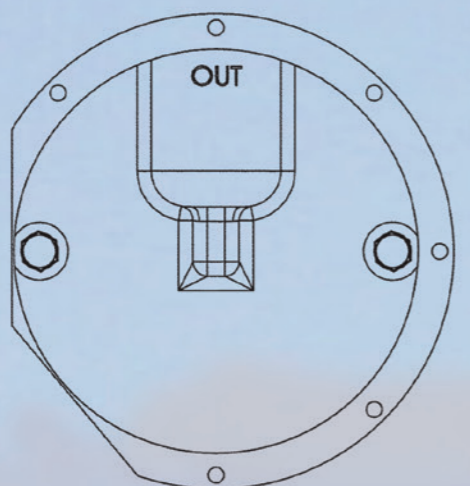

RAP441CC-23 & 441CC-23

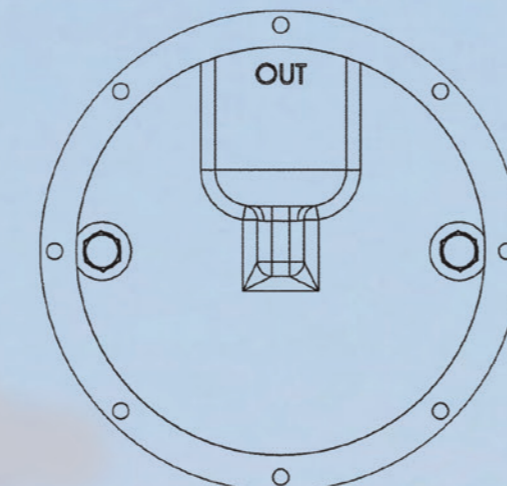

RAP442CW & 442CW

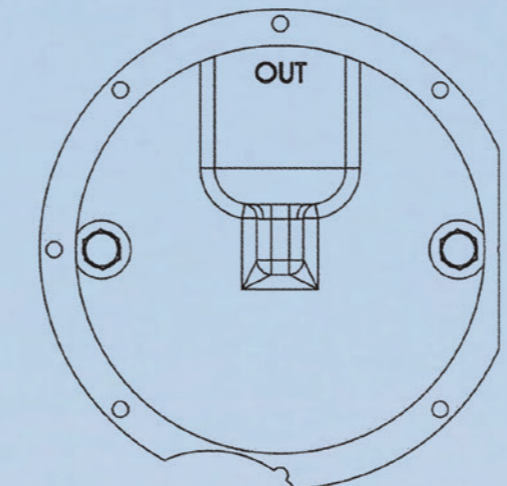

RAP442CW-4 & 442CW-4

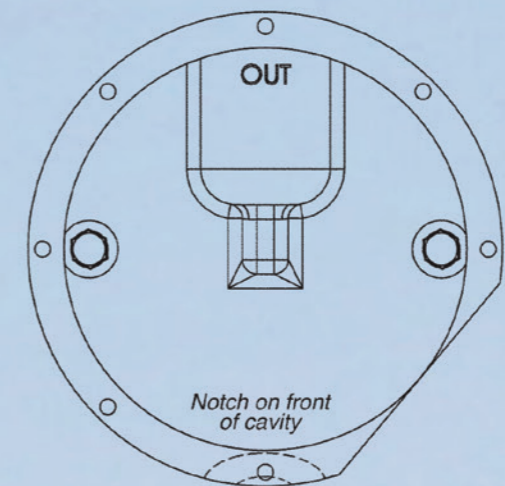

RAP442W-6 & 442CW-6

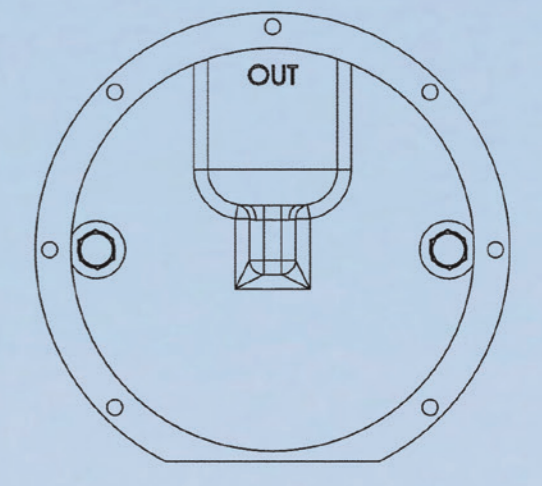

RAP442CW-8 & 442CW-8

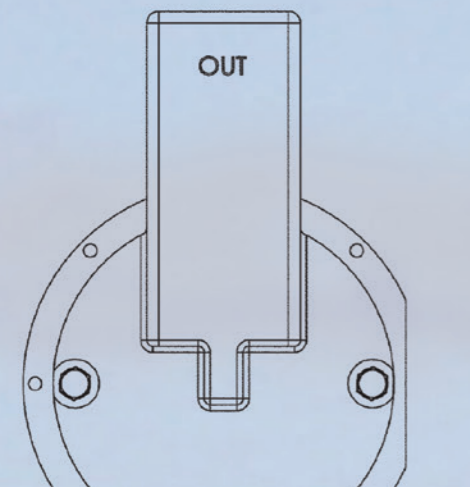

RAP442CW-12 & 442CW-12

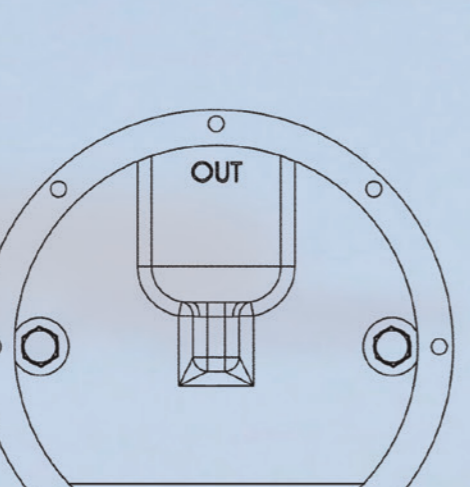

RAP442CW-14 & 442CW-14

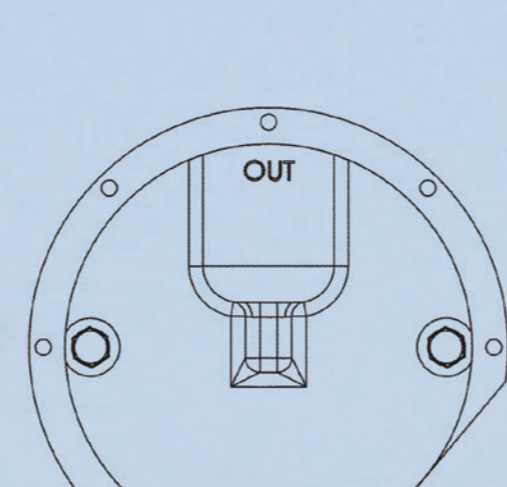

RAP442CW-20 & 442CW-20

- A.** Inspection port allowing for on-aircraft measurement
  - B.** Chamfered rotor allowing for small foreign objects to pass
  - C.** Oil seal to help prevent fluid contamination
  - D.** Mil-Spec coated cavity to reduce friction
- .... and of course it saves you and your customers money

