

Installation Instructions for King Air NSA Sunvisor System

RBKA-300-NSA-1

(R1160006-0)

This is an FAA STC'd installation requiring a logbook entry upon completion.

Doc: 9051-0116-011

Rev	Date	Approved
B	4/19/2007	GH

Installing your Rosen Sunvisor System is easily performed and should take approximately 15 minutes.

Please read these short instructions **COMPLETELY** before starting.

Tools required:

Phillips screwdriver

3/32 Hex Key

5/32 Hex Key

9/64 Hex Key

Installation Hardware (included):

Qty:	(4)	A8K75	8-32 Rivnut
	(4)	AN526C832R10	8-32x5/8 PHTSS
	(4)	AN526C832R12	8-32x3/4 PHTSS
	(4)	MS24671-14BP	8-32x1/2 FSHCS
	(2)	1160103	Mounting Bracket

- These units are screw-in replacements for any older King Air with the ball joint style arm visor.
- Rivnuts are supplied to allow them to be installed in newer King Air's that have the Beech rail system.
- In older aircrafts, simply remove the original equipment and replace them with the Rosen units, installing the visors as marked for pilot and co-pilot side.
- If you have the royalite trim covering the mounting plate on the original equipment, you may elect to remove this and install between the Rosen mounting plate and swivel.
- Mark holes for the attach screws for the Rosen swivel and drill Royalite trim piece and then reinstall
- For aircraft that use the later Beech 1/2" diameter rail, rivnuts are included.
- You may have extra screws.

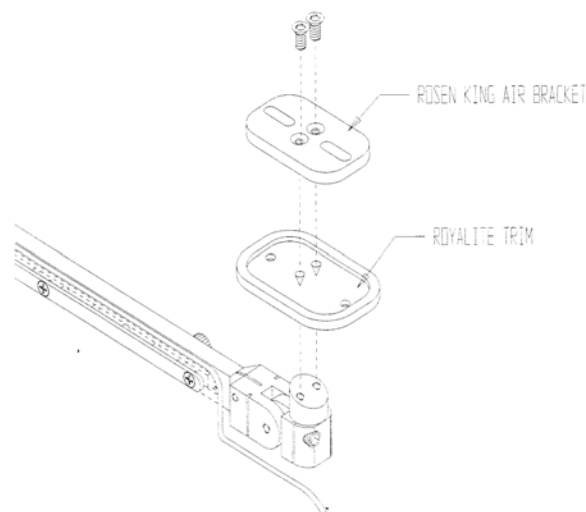

Continued Airworthiness Instructions:

- **(On the ground only)**
 - Periodically clean the lenses with a soft cloth, mild soap and water or an approved aviation grade windscreen cleaner. Do not use abrasives on the lens.
 - Periodically adjust the pivot tensions on the visor assemblies.